

February 10, 2017

Gilbane Construction Update

Activities in progress as of February 10, 2017:

- ▶ Interior stone veneer installation on Area F Vestibule in progress.
- ▶ Curtain wall installation on Area E Cedar level Reading Area started.
- ▶ Painting overhead structural steel & decking on Area E Cedar level Dining Commons started.
- ▶ Casework installation on Areas B & E 2nd floor in progress.
- ▶ Painting on Area C 2nd floor & Area G Cedar Level Stage in progress.
- ▶ Cord reel installation in science classrooms on Area A 3rd floor started.
- ▶ Ceiling grid on Area D Cedar level Kitchen started.
- ▶ Metal pan stair installation on Area C Washington level Scene Shop in progress.
- ▶ Lighting installation on Area C Washington level Auxiliary Gym started.

Upcoming Project Milestones:

- ▶ Vocal level wood flooring installation scheduled to start on 02/20/17.
- ▶ Competition Gym telescoping bleacher installation scheduled to start on 03/17/17.

Construction Key Plan:

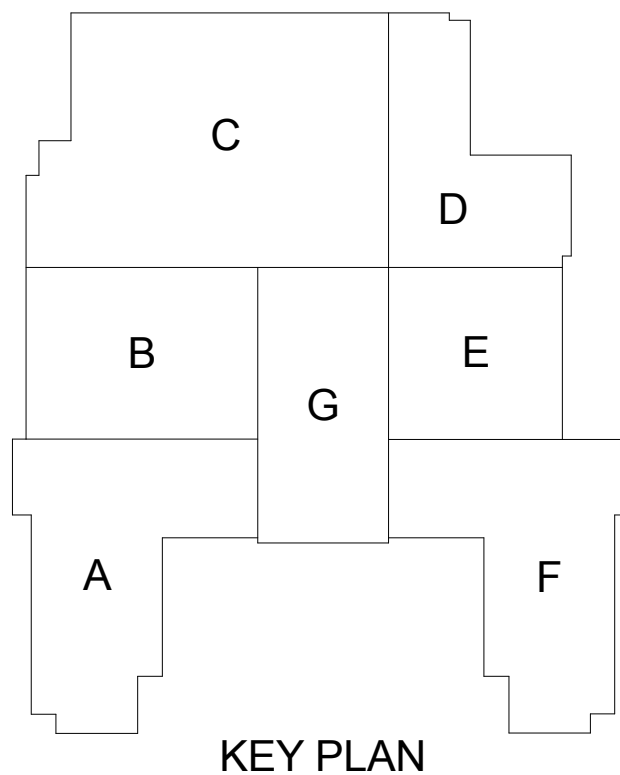



Casework Installation in Areas B & E 2nd Floor



Painting Stage in Area G Cedar Level Auditorium



Interior Masonry Stone Veneer Installation in Area F Vestibule



Cord Reel Installation in Area A 3rd Floor



Curtain Wall Installation in Area E Cedar Level



Lighting Installation in Area C Washington Level

