

April 08, 2016

Gilbane Construction Update

Activities in progress as of April 08, 2016:

- ▶ Area F Cedar Level prepped for slab on grade pour
- ▶ Unsuitable soils stockpile being prepped for export
- ▶ Area F Cedar Level masonry in progress
- ▶ Demo for the new classroom openings thru the 1925 exterior wall started
- ▶ Buck hoist delivered; loading dock construction to follow
- ▶ Masonry restoration tuck pointing started
- ▶ Area E bar joists & structural steel in progress
- ▶ 1925 pan deck demo for new mechanical chases in progress
- ▶ Elevators #1 (Area A) & #2 (Area D) masonry shafts in progress
- ▶ Area B Competition Gym roofing in progress
- ▶ Area A underground duct complete & backfilled
- ▶ Area A Washington Level slab on grade poured
- ▶ Area C Mechanical Room & Area D masonry in progress

Upcoming Project Milestones:

- ▶ 1925 topping slab planned for week of 4/25
- ▶ Gym roofing planned for week of 5/2
- ▶ Geothermal piping installation planned for week of 5/2

Construction Key Plan:

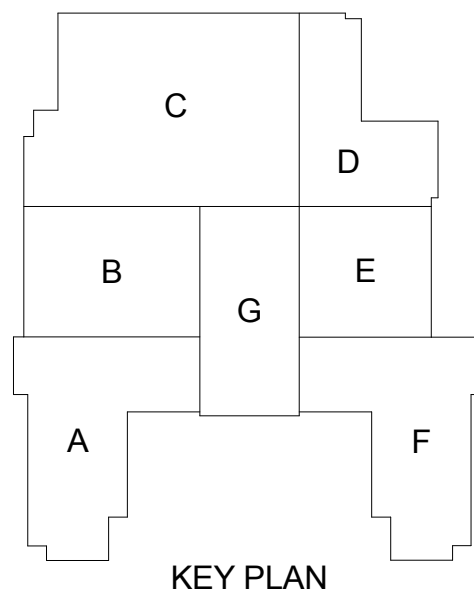



Courtyard showing the buck hoist that will be used to load material in the building



Area F Cedar Level being prepped for slab on grade



Area F structural steel



Area E structural steel in progress



Area C Mechanical Room



Area A Washington Level slab on grade poured

