

April 15, 2016

## Gilbane Construction Update

### Activities in progress as of April 15, 2016:

- ▶ Area F Cedar slab on grade partial pour
- ▶ Unsuitable soils stockpile export in progress
- ▶ Demo for the new classroom openings thru the 1925 exterior wall in progress
- ▶ Buck hoist loading dock construction started
- ▶ Masonry restoration tuck pointing in Courtyard & on roof in progress
- ▶ Area E bar joists & structural steel in progress
- ▶ New structural steel for mechanical chases in progress
- ▶ Elevators #1 (Area A) & #2 (Area D) masonry shafts in progress
- ▶ Cedar Level temporary lighting completed
- ▶ Ductwork installation in Area A & F Third floor in progress
- ▶ Elevator #3 (Area C) pit formwork in progress
- ▶ Area C footers being poured
- ▶ Area D Cedar Level masonry in progress

### Upcoming Project Milestones:

- ▶ 1925 topping slab planned for week of 4/25
- ▶ Gym roofing planned for week of 5/2
- ▶ Geothermal piping installation planned for week of 5/2

### Construction Key Plan:

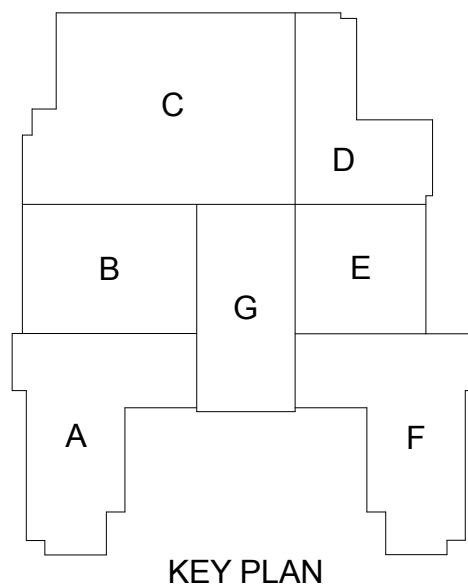



Area C Footers



Area F Cedar Level Slab On Grade



Area A Third Level Ductwork Installation



Area D Masonry



Courtyard Masonry Restoration & Buckhoist Deck Installation



Area E Structural Steel & Bar Joists

