

April 22, 2016

Gilbane Construction Update

Activities in progress as of April 22, 2016:

- ▶ Buck hoist loading dock & roof construction in progress
- ▶ Courtyard masonry tuck pointing in progress
- ▶ Demo for the classroom openings through the 1925 exterior wall in progress
- ▶ Demo for the new atriums in Areas A & F in progress
- ▶ Patching of the existing penetrations through the 1925 pan deck in progress
- ▶ Areas A & F 3rd floor duct & pipe hangers installation in progress
- ▶ Exterior stud framing in Area A Washington level started
- ▶ Footers in Area C in progress
- ▶ Masonry in Area D Washington level in progress
- ▶ Underground sanitary piping in Area C in progress
- ▶ Area C Washington level Mechanical Room slab on grade poured
- ▶ Electrical & technology in-wall rough-in in progress in Area D Washington level
- ▶ Unsuitable soils stockpile export complete
- ▶ Areas E & F roof decking in progress
- ▶ Area E underground fire main installed & tested

Upcoming Project Milestones:

- ▶ 1925 topping slab planned for week of 4/25
- ▶ Gym roofing planned for week of 5/2
- ▶ Geothermal piping installation planned for week of 5/2

Construction Key Plan:

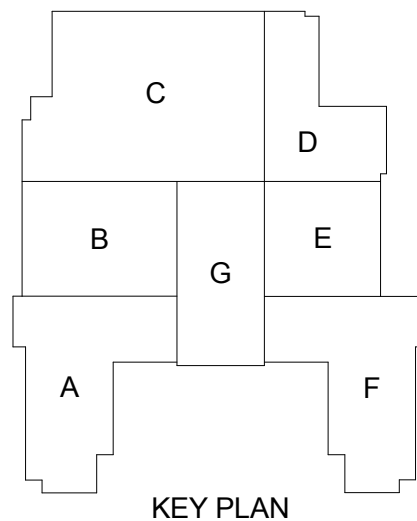



Area C footers



Area A 3rd Floor ductwork installation



Area A Washington level exterior studs starting



Area C Washington level Mechanical Room slab on grade poured



Courtyard masonry restoration & buck hoist construction



Area E roof decking & fire main underground being backfilled

