

June 24, 2016

Gilbane Construction Update

Activities in progress as of June 24, 2016:

- ▶ Sanitary piping on Cedar Level Areas A & F started
- ▶ Interior metal stud framing layout on Cedar Level Areas A & F in progress
- ▶ Interior metal stud framing on 2nd Floor Area A in progress
- ▶ Electrical in-wall rough-in on 2nd & 3rd Floor Areas A, F & G in progress
- ▶ Structural steel on 2nd & 3rd Floor Area F in progress
- ▶ HVAC duct & piping on 2nd Floor Area A & F & 4th Floor Area G in progress
- ▶ Exterior sheathing in Area F east & north elevation in progress
- ▶ Interior bathroom masonry partition walls on 3rd floor Area F in progress
- ▶ Mechanical rooms being prepped for paint
- ▶ Exterior stud framing on Area F north elevation & Area A west elevation
- ▶ Sprinkler piping installation on 3rd floor Area A started
- ▶ Interior stair riser installation in Area A south started
- ▶ New roofing installation on Area A north & west in progress
- ▶ Masonry veneer wall ties on Area A west elevation in progress
- ▶ Masonry Area C Washington Level & Area D Cedar Level in progress
- ▶ Underground sanitary piping Area C in progress
- ▶ Grading east roadway in progress
- ▶ Geothermal well field piping installation in progress
- ▶ Prep Area A Washington Level for slab-on-grade

Upcoming Project Milestones:

- ▶ Brick veneer installation Area A west elevation start week of 7/4
- ▶ Precast Cedar Level Area C week of 6/27
- ▶ Roof steel installation Area D week of 6/27

Construction Key Plan:

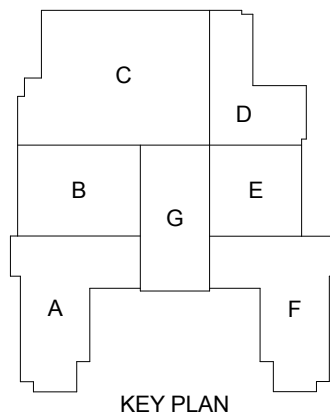



Exterior Sheathing Area F East Elevation



Masonry Walls Area C Washington Level



Grading East Roadway



Sprinkler Piping Third Floor Area A



New Roofing Area A North



Prep Mechanical Rooms for Paint

