

September 30, 2016

Gilbane Construction Update

Activities in progress as of September 30, 2016:

- ▶ Window installation on Area F east elevation, Area A west elevation & courtyard in progress.
- ▶ Geothermal well field piping & backfill complete.
- ▶ Cast stone masonry veneer on Area E east elevation in progress.
- ▶ Grading on ballfield and west drive in progress.
- ▶ Area C Auxiliary Gym exterior masonry in progress.
- ▶ Natatorium wood roof decking complete.
- ▶ Clock tower new clock faces installed.
- ▶ Curbs & sidewalk prep started on along Washington Blvd.
- ▶ Lighting installation in Competition Gym Area B Washington Level in progress.
- ▶ AHU-14 equipment pad poured in Area G Washington Level.
- ▶ Interior masonry Area C Washington Level in progress.
- ▶ Spray-on-fireproofing in progress on Area E Dining Commons trusses in progress.
- ▶ Topping slabs poured in Area C Cedar Level.
- ▶ Paint & ceiling grid installed in Mock-Up room on 3rd floor Area G.
- ▶ Drywall installation & finishing on 3rd floor Areas in progress.
- ▶ Data wire pulling & rack installation in data rooms in Area A 3rd floor in progress.
- ▶ Metal stud framing in Area G 4th floor & Area A Washington Level in progress.

Upcoming Project Milestones:

- ▶ Pool excavation scheduled week of 10/3.

Construction Key Plan:

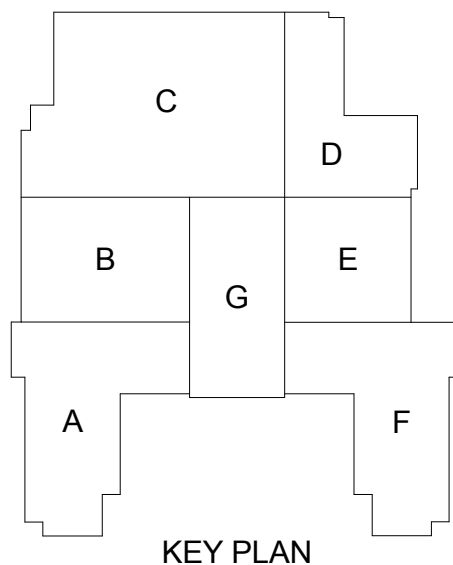



Clock Tower Restoration



Mock-Up Room Painting & Ceiling Grid



HVAC & HVAC Pipe Hangers



Area A Washington Level Metal Stud Framing



Area A 3rd Floor Data Room



Curbs & Sidewalk Prep Work

