

October 14, 2016

## Gilbane Construction Update

### Activities in progress as of October 14, 2016:

- ▶ Windows on Area F east elevation in progress.
- ▶ Light pole base on east drive poured.
- ▶ Window installation on Area E east elevation started.
- ▶ Veneer stone on Area F north & east elevation started.
- ▶ Auxiliary gym masonry walls in progress.
- ▶ First Energy transformer installation in Area D started.
- ▶ Gable roof truss installation in Area C in progress.
- ▶ Pool excavation in Area C Washington level started.
- ▶ Natatorium rubber roofing over wood decking in Area C in progress.
- ▶ Curbs, sidewalks & frost slabs in progress on west drive.
- ▶ Kitchen MEP rough-ins in Area D Cedar level started.
- ▶ HVAC ductwork in Area E Cedar level in progress.
- ▶ Metal stud framing in Area G Art level in progress.
- ▶ Lights & devicing in mock-up room on Area A 3<sup>rd</sup> floor.
- ▶ Roofing on 1925 building Area A in progress.

### Upcoming Project Milestones:

- ▶ Paving scheduled for the week of 10/17.
- ▶ Permanent power installation in progress.

### Construction Key Plan:

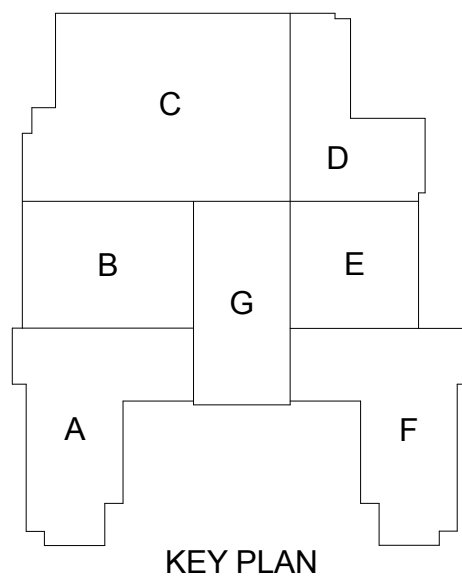



Veneer Stone & Window Installation Areas E & F



Pool Excavation Area C Washington Level



Curbs, Sidewalks & Frost Slabs West Drive



Rebuilding Parapet Area A Roof



Loading Dock Retaining Wall Construction Area D



Metal Stud Framing Area G Art Level

