

November 04, 2016

## Gilbane Construction Update

### Activities in progress as of November 04, 2016:

- ▶ Exterior window caulking in progress.
- ▶ Sidewalk & curb installation on east drive in progress.
- ▶ West drive prep for asphalt pavement.
- ▶ Pool wall buttress construction in progress.
- ▶ Spray foam in Area C Auxiliary Gym north elevation in progress.
- ▶ Masonry in Area C Auxiliary Gym Washington level in progress.
- ▶ Slab-on-grade poured in Area C Auxiliary Gym Washington level.
- ▶ Permanent power established.
- ▶ Masonry veneer stone in Area E east elevation in progress.
- ▶ Area E Outdoor Plaza prep for slab-on-grade in progress.
- ▶ Areas A & F atrium ceiling construction started.
- ▶ Kitchen MEP rough-in in progress in Area D Cedar level.

### Upcoming Project Milestones:

- ▶ Paving scheduled for the week of 11/07.
- ▶ Auxiliary Gym structural steel scheduled for week of 11/07.

### Construction Key Plan:

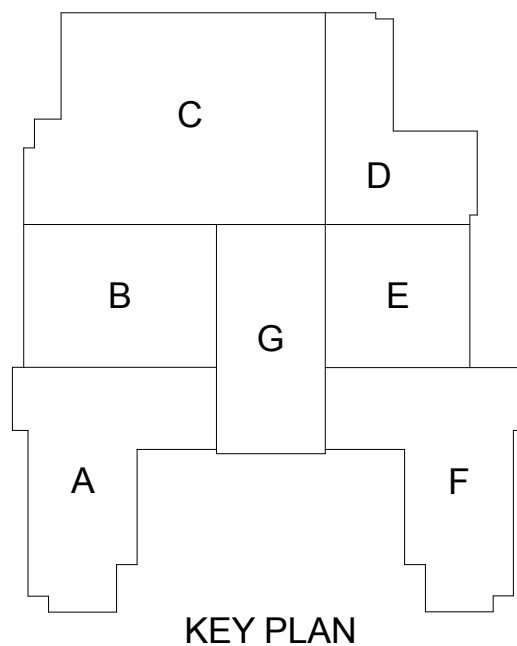



Area E Outdoor Plaza Prep for Slab-On-Grade



Area C Auxiliary Gym Slab-On-Grade Poured



East Drive Curbs & Sidewalks Installations



Area A & F Corridor & Atrium Ceilings



Area C Washington Level Natatorium Construction



West Drive Prep for Asphalt Pavement

