

November 18, 2016

Gilbane Construction Update

Activities in progress as of November 18, 2016:

- ▶ Asphalt paving intermediate course on east road, west road & Washington parking completed.
- ▶ Cast stone veneer on Area F south elevation & Area C north elevation in progress.
- ▶ Metal panel veneer on Area A north elevation started.
- ▶ Prep for concrete floor pour in Area C Washington level in progress.
- ▶ Roof decking on Auxiliary Gym in Area C Washington level in progress.
- ▶ Area D Service Area loading dock leveler pit & raised curb poured.
- ▶ Metal stud framing in Area E Cedar level in progress.
- ▶ Vaulted gypsum ceiling framing in Area G 3rd floor started.
- ▶ Casework installation in Area A 3rd floor started.
- ▶ Lighting in Area A 3rd floor started.
- ▶ Ceiling tile borders in Area A 3rd floor started.
- ▶ Roofing on Area C in progress.

Upcoming Project Milestones:

- ▶ Finish flooring scheduled to start week of 11/28/16.

Construction Key Plan:

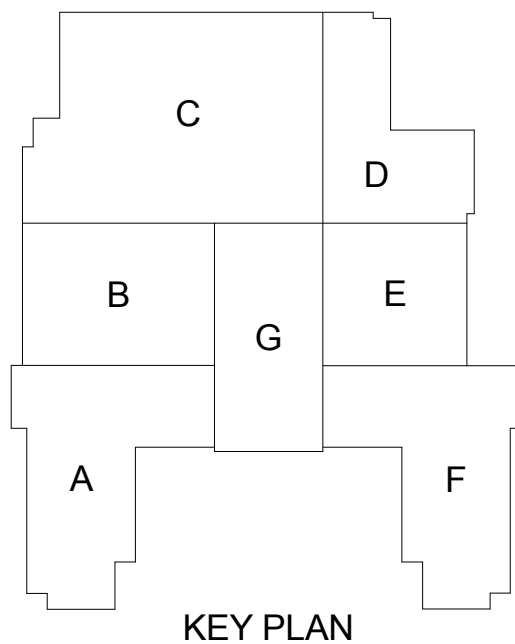



Casework Installation in Area A 3rd Floor



Prep for Pool Concrete Floor in Area C
Washington Level



Metal Panel Veneer on Area A North Elevation



Courtyard Construction



Cast Stone Veneer on Area C North Elevation



Asphalt Paving Intermediate Course on East
Road

